

WHITE BEAR PKWY BUSINESS CENTER I

4815-4817 WHITE BEAR PKWY | WHITE BEAR LAKE, MN



SPACE AVAILABLE:

10,518 SF - OFFICE

7,082 SF - WAREHOUSE

ASKING RATE:

\$9.50/SF - OFFICE

\$4.50/SF - WAREHOUSE

2018 TAX & CAM:

\$2.20/SF - TAX

\$1.78/SF - CAM

\$3.98/SF - TOTAL

PROPERTY HIGHLIGHTS

- Approx. 46,961 total building square feet
- Direct visibility and accessibility to I-35E
- Near many retail shops, restaurants and hotels
- 20' clear height
- One (1) dock with the ability to add more
- 190+ striped parking stalls
- Owned and managed by CSM Corporation



WHITE BEAR PKWY BUSINESS CENTER I

4815-4817 WHITE BEAR PKWY | WHITE BEAR LAKE, MN

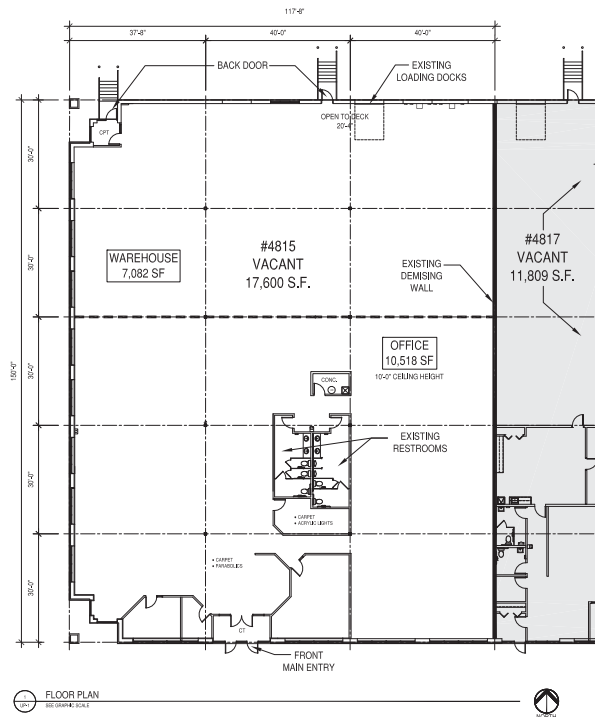

AS-BUILT UNIT PLAN

UNIT	AS OF	VERSION
4815	6/22/16	UP - 1

TENANT SUMMARY	
OFFICE AREA	10,518 SF
WAREHOUSE	7,082 SF
TOTAL	17,600 SF

----- DASHED LINE INDICATES OFFICE/
WAREHOUSE SEPARATION



JAY CHMIELESKI
Managing Director

D +1 612 430 9982
M +1 612 275 3772
jay.chmielewski@ngkf.com

DAN FRIEDNER
Managing Director

D +1 612 430 9991
M +1 612 599 7864
dan.friedner@ngkf.com

PATRICK CULLEN
Associate

D +1 612 430 9995
M +1 651 308 4271
patrick.cullen@ngkf.com

www.ngkf.com

The information contained herein has been obtained from sources deemed reliable but has not been verified and no guarantee, warranty or representation, either express or implied, is made with respect to such information. Terms of sale or lease and availability are subject to change or withdrawal without notice.

